



true associates

CHARTERED SURVEYORS | PROPERTY MANAGERS | ESTATE AGENTS

Harvist Road Queens Park, NW6



Two Bedroom Garden Flat

£575,000 – Leasehold

Fabulous two bedroom garden flat in the sought after Queens Park area. Seconds away from the actual park and its amenities and only minutes away from the trendy bars and restaurants of Salusbury Road. Boasting an extended family room, incorporating a fully fitted kitchen, diner and living area looking out to a landscaped garden with eco friendly office at the rear. An opportunity not to be missed!



Entrance Hall:

“Attic” storage space created under stairs together with large storage cupboard. Walnut flooring.

Open Plan Reception/Dining

Room : 14'8 x 11'5 & 12'7 x 10'11

Velux sky lights/concertina doors to rear, patio doors to side elevation, walnut flooring



Kitchen: 8'1 x 7'10

Breakfast bar, wooden worktop, fully fitted, spotlights, walnut flooring



Bedroom One: 15'2 x 13'2

Window to rear aspect, carpeted, large built in wardrobes

Bedroom Two: 13' x 11'11

Large bay window, plantation shutters, carpeted, working fireplace, features ceiling rose and cornicing, ample storage



Bathroom:

Fully tiled, shower/bath, spotlights and heated towel rail

Garden: 53'2 x 18'8

Raised decking leading to landscaped lawn with eco friendly office towards rear

External utility room to side elevation

Tenure: 114yr Leasehold

Ground Rent: £150 p/a

Service Charges: £250 p/a



map

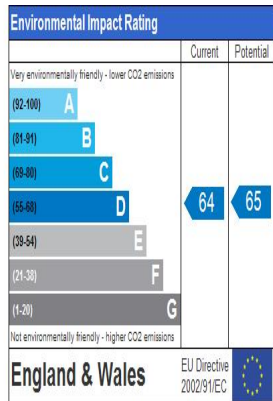
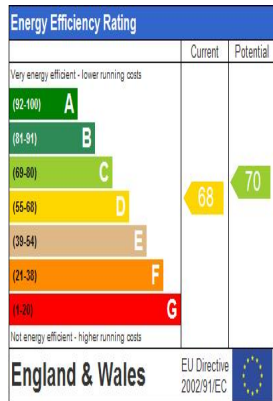
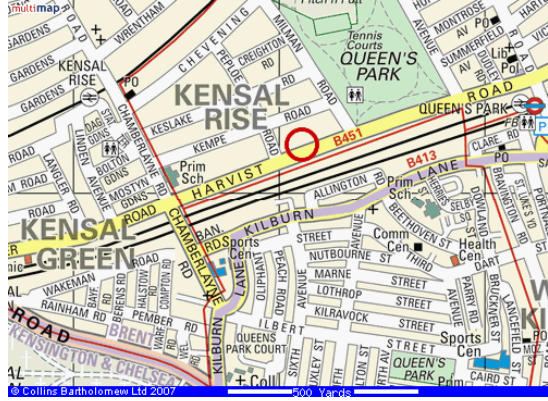

Floorplan

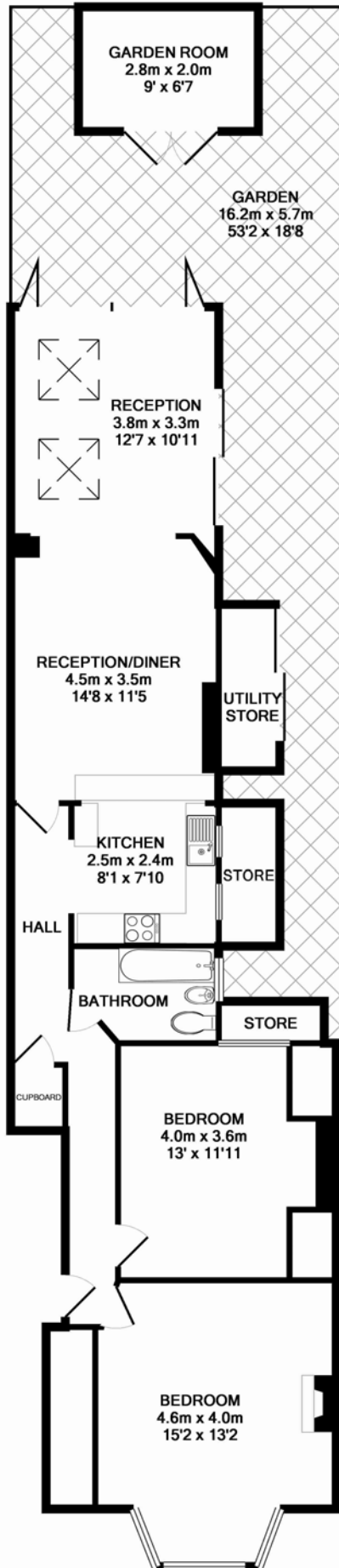

TOTAL APPROX. FLOOR AREA 79.2 SQ.M. (853 SQ.FT.)

